



infiniti fires

INFINITI WOOD STOVES

A NEW GENERATION IN HEATING



Photo courtesy of SA Homeowner



Photo courtesy of SA Homeowner

INFINITI FIRES™ FIREPLACES AND THE ENVIRONMENT

The Infiniti Fires range of superior gas and wood fires is the result of extensive research around South African consumer requirements in home heating.

A group of South African fireplace industry experts have combined their knowledge, to ensure that Infiniti's fireplace products are:

- Capable of effectively heating South African homes
- Highly efficient, making optimal use of the fuel burnt
- Easy to use and safe
- Economically viable heating solutions
- Environmentally friendly
- Modern looking to complement today's architecture

We feel sure that in perusing this brochure or visiting us on www.infinitifires.co.za you will find a fire to suit your specific application. A full list of dealers around South Africa that can assist you further with competent advice, qualified installation teams and after sales service is available on our website.

OPEN WOOD FIRES, DAMPER UNITS & BASKET GRATES

There is a call from people wanting to have an open fire that looks like a traditional brick fireplace. To build this type of fire to not smoke involves some complexity in building a smoke shelf and chimney of the right proportions.

Our steel damper units come in a range of sizes from 850mm to 1500mm wide. They have all the right sizes and proportions to collect the smoke and push it up the chimney. They are built into the brick chimney directly above the fireplace opening, so that they are not visible from the room. This gives the effect of an open brick fireplace without the worry of going the more complex brickwork route.

In addition to the ease of installation, our damper units have an adjustable chimney control designed to maximise heat from the fire- a considerable improvement over a normal brick fireplace. Couple the damper with one of our Basket Grate and Pans, providing a sturdy grate to hold the burning embers and an ash-pan located beneath the grate for easy cleaning of the ashes.

Refer to page 9 for details of damper units and Basket grate and Pans.

CLOSED COMBUSTION WOOD STOVES (CCWS): THE FACTS

- CCWS are rated around the world at being both efficient & environmentally friendly home heating.
- Wood being burnt in our stoves reaches a combustion temperature in excess of 900°C. At these temperatures, wood is burnt at nearly 80 % efficiency, wasting very little in the way of heat into the atmosphere.
- Flue emissions from wood being burnt in our stoves are less than if the wood had rotted naturally in the forest. If you are growing trees and burning the excess /dead wood your contribution towards global warming is nil from a CCWS .
- The cost of heating (assuming you are buying wood at about R 1200 per tonne) is about 45 c per kwhr. About 20% of the price of electricity in SA. The cost of installing one of our stoves in your home will typically be paid off in about 2 years of savings in electricity bills.
- Warming your home with a CCWS, instead of electricity, will reduce electrical demand by about 10 000 KwHrs per year. This change in your home will save Eskom burning 4 tonnes of coal and using many thousands of litres of water per year. For a country with high air pollution and scarce water, something we should all be looking at.

SPECIAL FEATURES OF OUR WOOD STOVES INCLUDE:

A full vermiculite jacket inside the fire. This insulating material raises the combustion temperature inside the fire to in excess of 950°C. At these temperatures the wood burns highly efficiently sending very little emissions into the atmosphere. The high temperature combustion sends about 70% of the heat of the fire out through the door glass as an infrared light wave. This enables the heat to travel long distances across the room and keeps the heat down where you want it, particularly important in open plan/double volume spaces.

A long, slow burn time so that the fire can comfortably burn through the night or whilst we are out during the day. We have found that with a full load of good quality wood, the 8kw stove can burn at slow pace for up to 12 hours and the 13kw stove up to 15. Feats hitherto unheard of on any wood stove sold in South Africa.

INFINITI 8kw Cube c/w Wood Storage Table



INFINITI 8 Kw Freestanding (Leg look)



INFINITI 10 Kw Curve



INFINITI 14 Kw Double Sided Convection Unit with Storage Box



8KW FREESTANDING

This freestanding unit comes standard with 80mm high legs and a conversion plate. By simply removing two screws and fitting the conversion plate, the unit can be changed to create a cube effect.

These units can be installed either sitting on floor tiles or a hearth, or can be installed on top of our wood storage table, thereby creating a range of looks from the same unit.

The units all have rear heat deflector plates, enabling them to be installed 150mm off plaster walls. A snug fit for best look.

These units are available with both top and rear flue exits.

Heating capacity of 8kw / 320m³.



INFINITI CURVE UNITS

Our new 10 & 12 Kw Curve units are designed with gentle curves on either side to give this unit a smooth oval look. The larger convection chamber and ventilated top plate, enhances air circulation to improve the efficiency of the unit, as well as decreasing the temperature of the steel side walls for a safer touch by hands.

The unit functions equally well whether positioned on a flat wall or orientated across a corner.

These units are available with both top and rear exit flue options.

Heating Capacity
10 Kw/400 m³
12 Kw/480 m³

10, 13, 14 & 18 KW FREESTANDING RANGE

These units are available as:

	10 Kw	13 Kw	14 Kw Double Sided	18 Kw Single & Double Sided
Black Legs	✓	✓		✓
Stainless Steel Legs	✓	✓		
Convection Unit	✓	✓	✓	✓
Optional Wood Storage Box	✓	✓	✓	✓
Heating Capacity	400m ³	520m ³	560m ³	720m ³

Convection Units can either be positioned on a non-combustable surface or used with the optional wood storage box, to raise the unit and provide space for 1 to 2 days wood storage. Our 18 Kw Single & Double Sided Convection units can be positioned on a non combustable floor, on an optional Wood Storage Box or on a set of elegant legs. See page 10 for details.

INFINITI 18Kw Double Sided Convection Unit with Wood Storage Box



INFINITI 13 Kw Insert



Photo courtesy of SA Homeowner



INFINITI 13 Kw St Steel Leg Unit



INFINITI 13 Kw Black Leg Unit

INFINITI WOOD INSERTS

Infiniti's wood stoves are available as inserts. Using the same tried and trusted fireboxes as the freestanding units, these models are designed to be built into brickwork to give you that swisher look. They are manufactured with a built-in convection system. This funnels air around the outside of the hot firebox, bringing it back into the room as hot air. This increases the efficiency of the unit to just below that of the freestanding unit.

They are ideal for those existing homes that have a brick chimney as well as for new homes/renovations where chimneys are to be built. With the same high temperature combustion and long burn times of the freestanding units, these inserts are capable of heating large areas of home.

Available as standard with a 40mm black frame.

Available in the following versions:

Unit	Heat (Kw)	Heat (m ³)
Single Sided Insert	8kw	320
	10kw	400
	13kw	520
	18kw	720
Double Sided Insert	14kw	560
	18kw	720



INFINITI 10kw Insert



WOOD INSERTS TO CONVERT EXISTING BUILT IN JETMASTER UNIVERSALS

These Infiniti inserts are designed to easily convert existing built in Jetmaster units to high efficiency wood stoves. By using a cutting torch or plasma cutter to cut away the unwanted internal parts of the existing Jetmaster, enough space is created, that you are able to slide our insert into the external remains of the Universal. Our steel frame covers up to the external dimensions of the existing Universal frame to give a tidy fit.

This means that our insert can be completely installed in less than a day without any damage or re-work to the walls around the existing universal. This saves a lot of dust and disruption to the room as well as minimising the costs of changing to our powerful heat output insert.

Available in the following versions:

Unit	Heat (Kw)	Heat (m³)	Converts
10 Kw Conversion	10kw	400	700D Universal
14 Kw Double Sided Conversion	14kw	560	700 Double Sided Universal
18 Kw Conversion	18kw	720	1050 Universal
18 Kw Double Sided Conversion	18kw	720	1050 Double Sided Universal



Insert being slid into 700 Double Sided Universal



Completed Look

OPEN WOOD FIRES DAMPER UNIT

Typical Installation Detail

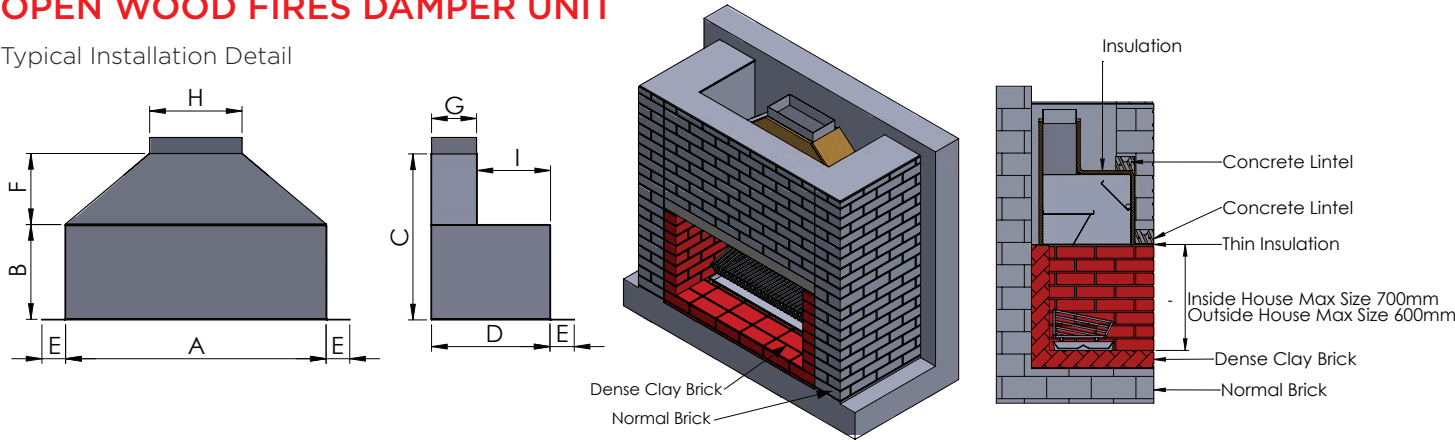

Product	a	b	c	d	e	f	g	h	1
850 Damper	900	400	650	455	100	250	200	300	265
1050 Damper	1100	400	700	505	100	300	200	400	310
1200 Damper	1250	400	700	505	100	300	350	500	155
1500 Damper	1550	400	700	505	100	300	350	500	160

Circular Flue
275mm Diameter
300mm Diameter
N/A
N/A

BASKET GRATE & PAN

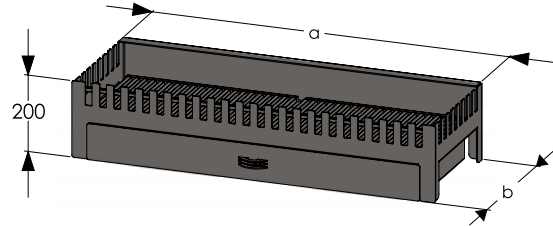

Product	a	b
600 Model	570	280
700S Model	670	280
700D Model	670	345
800 Model	780	345
1000 Model	960	345
1200 Model	1145	425

WOOD STOVE - WOOD STORAGE TABLES

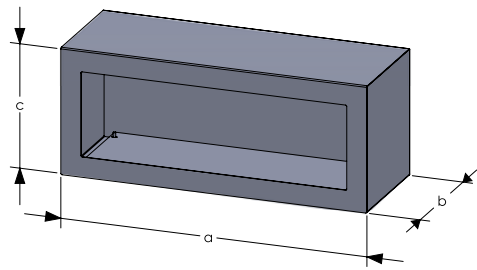

	a	b	c
Long Storage	1215	450	500
8Kw	621	450	500
13Kw	870	405	500
14Kw D/S	750	629	500
18Kw	1100	482	500
18Kw D/S	1100	502	500

D/S units have securing lips on top of tables to hold wood stove secure

FREESTANDING WOOD STOVES C/W LEGS

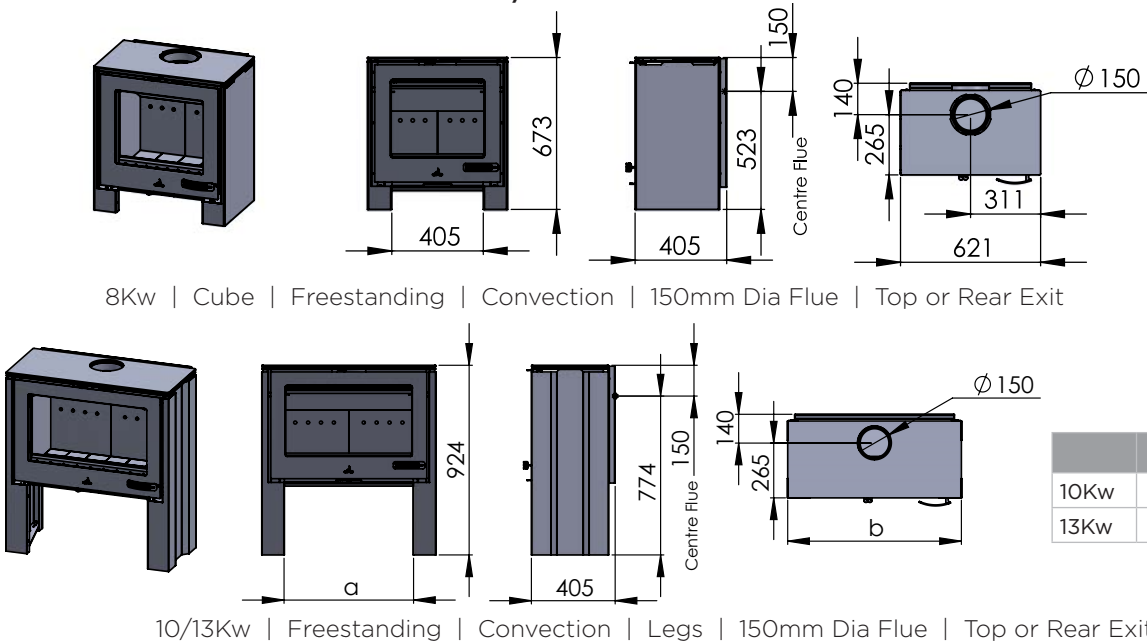

	a	b
10Kw	510	726
13Kw	628	849

CURVE

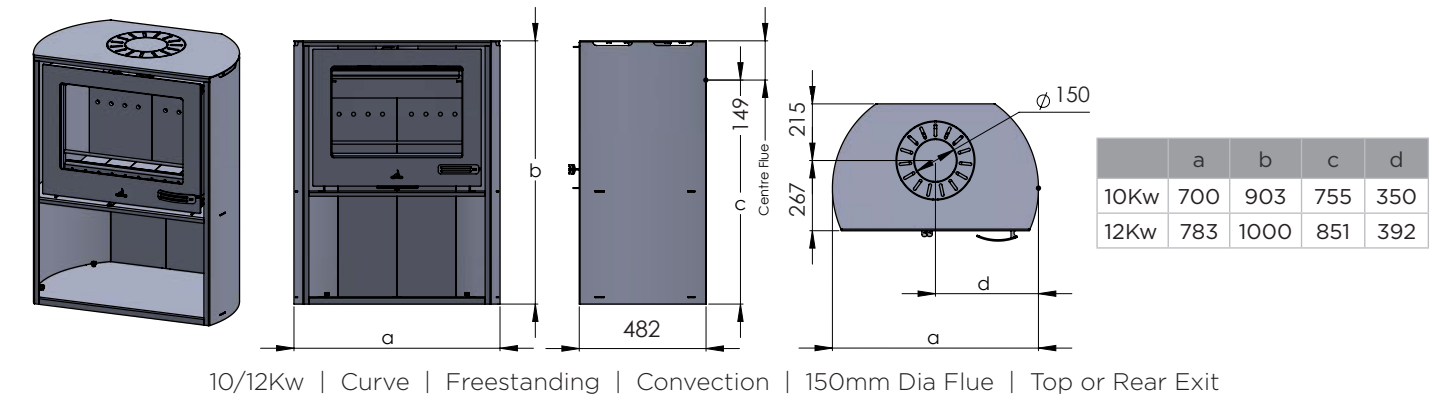

FREESTANDING WOOD STOVES C/W CONVECTION BOXES

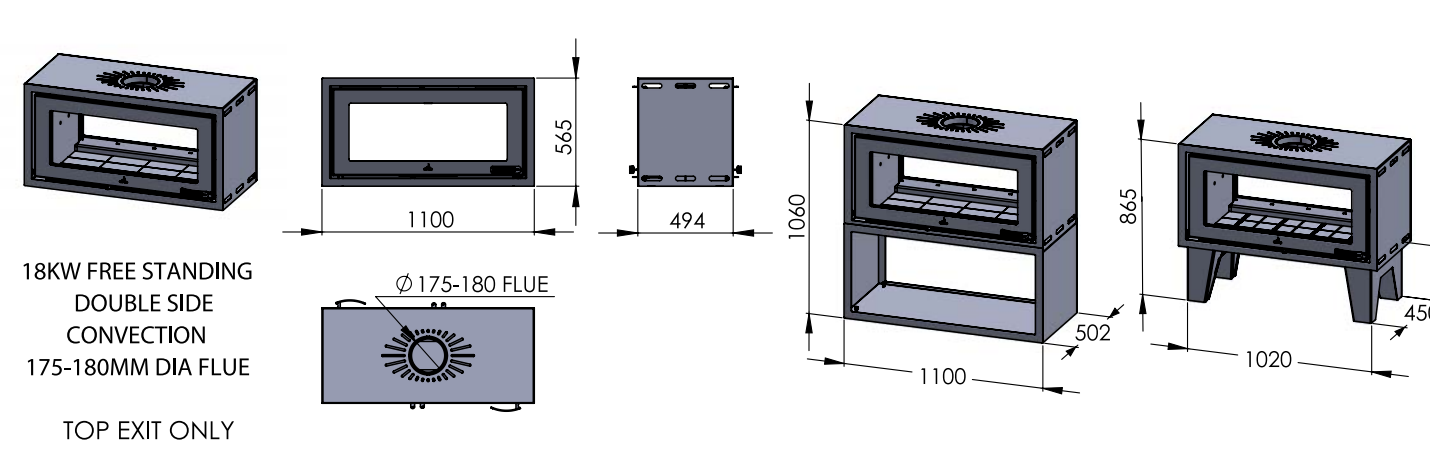
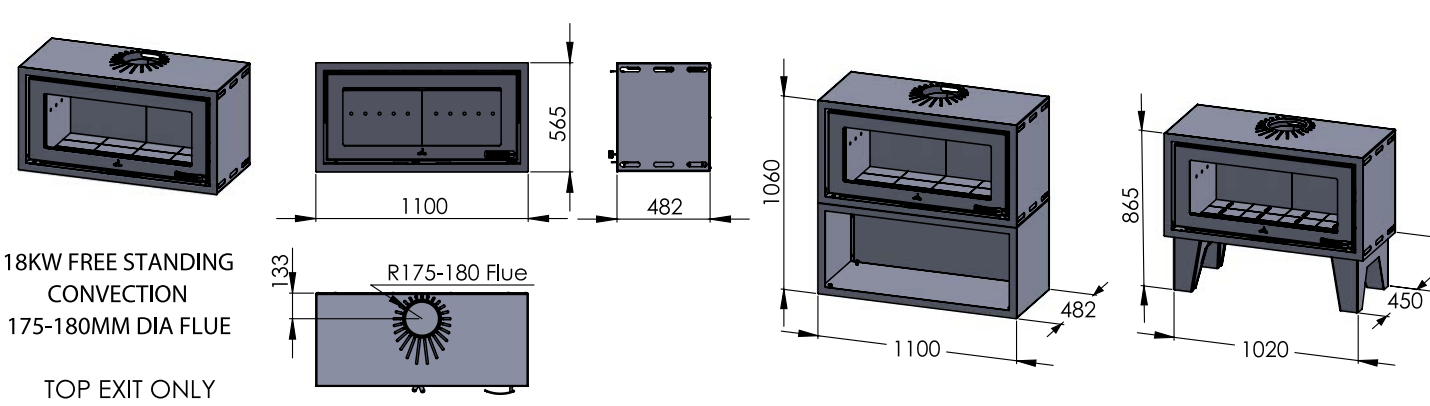
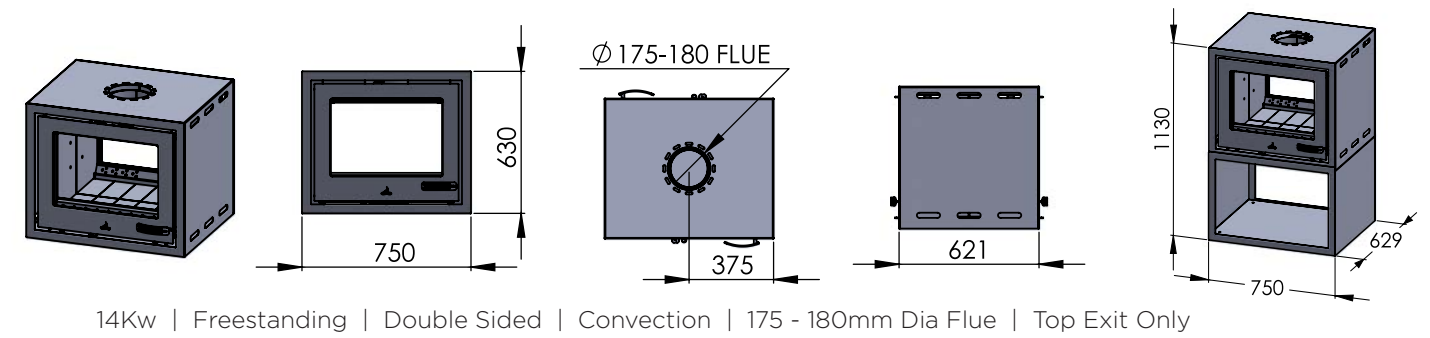
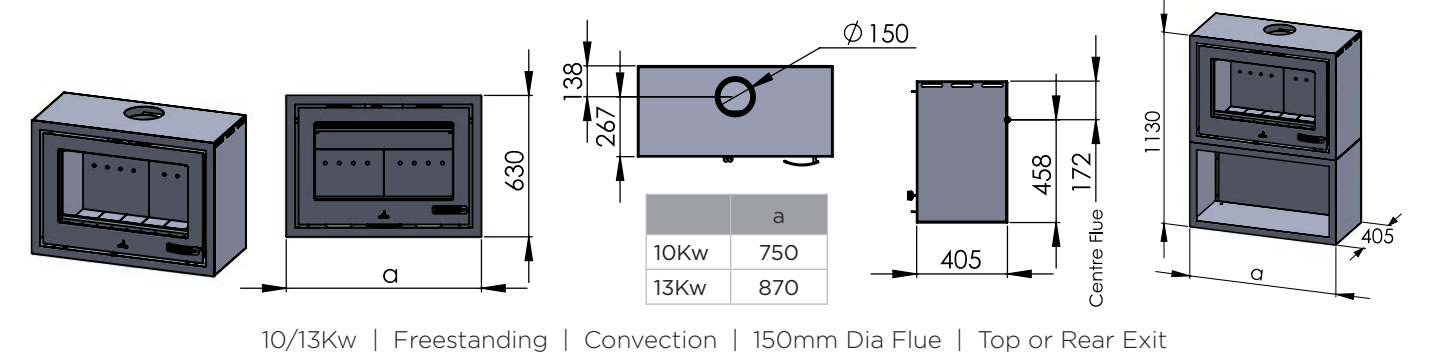

BUILT IN WOOD STOVES NEW BUILD

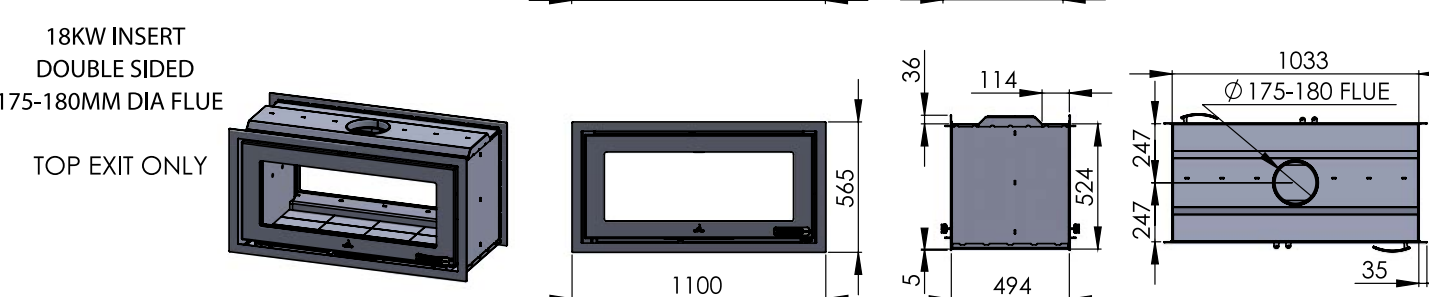
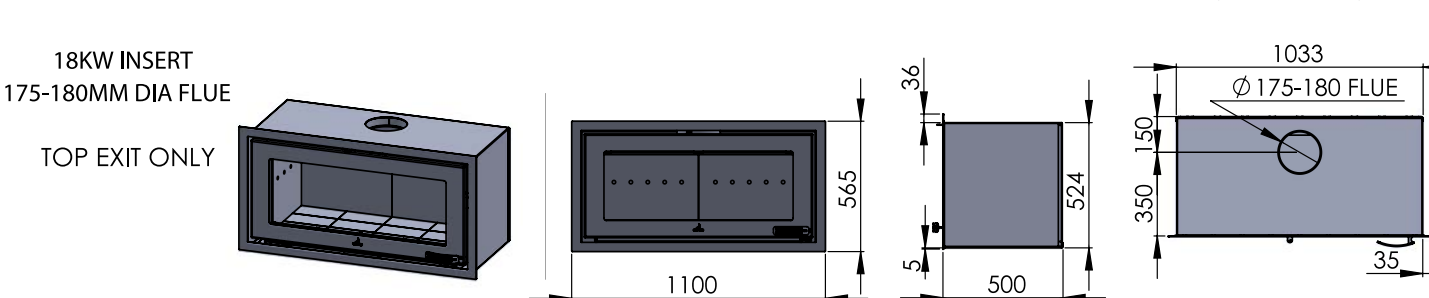
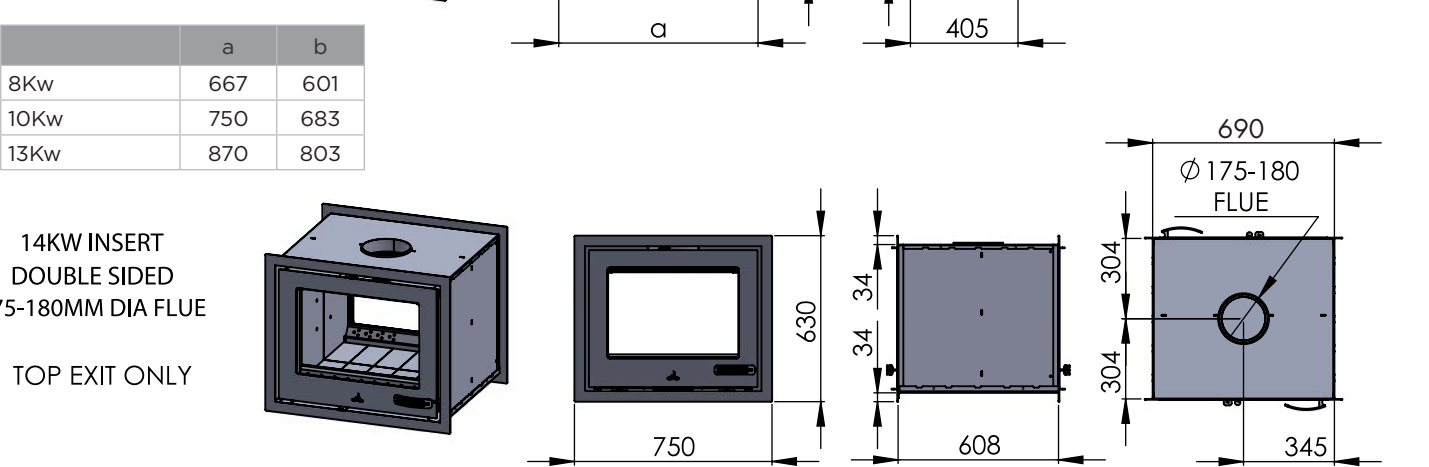
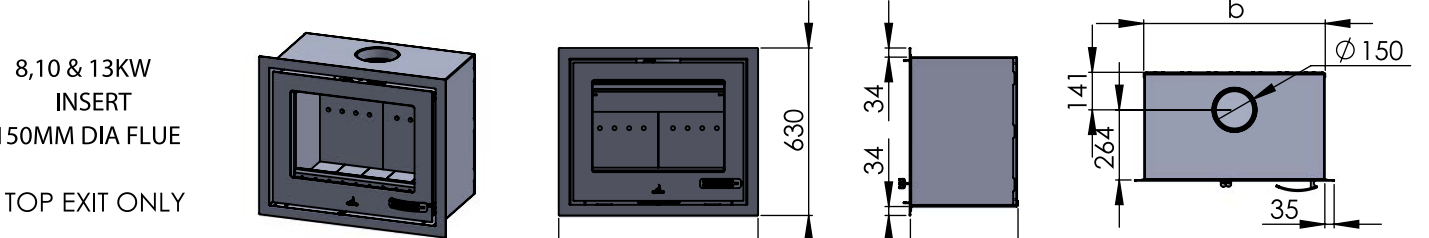

BUILT IN WOOD STOVES TO CONVERT JETMASTER UNIVERSALS

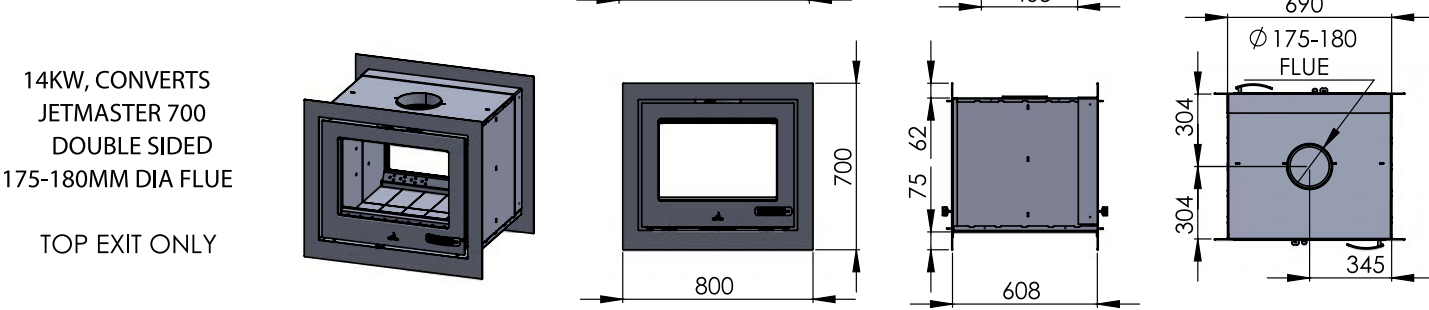
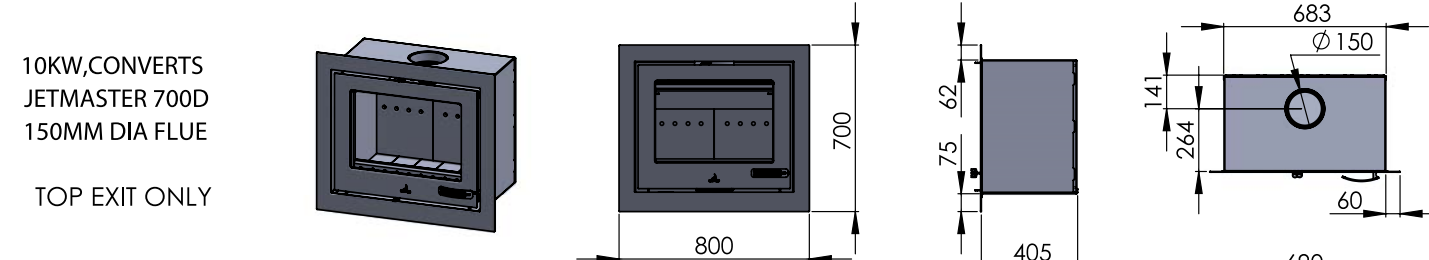

BUILT IN WOOD STOVES TO CONVERT JETMASTER UNIVERSALS (CONT)

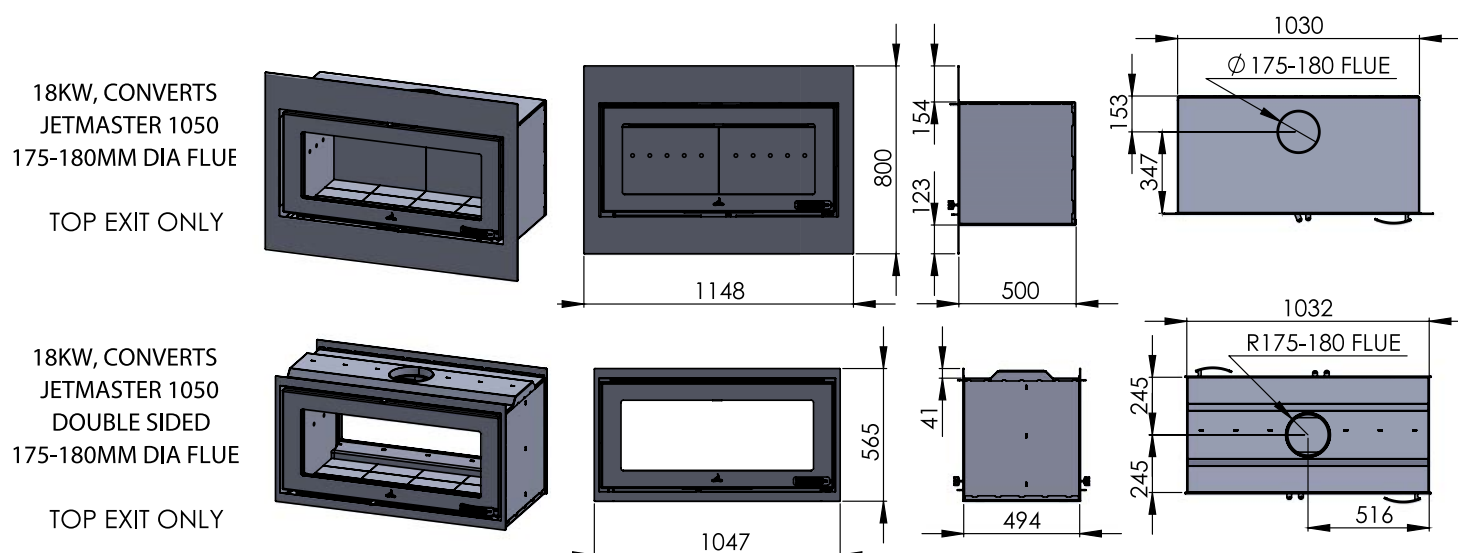

TOP DOWN LIGHTING

For centuries savvy owners of open wood fires have used a Top Down Lighting method to best ignite wood in their fires. These same principles apply in Wood Stoves.

Place the bigger pieces of wood on the base of the stove and stack the wood with air gaps between the pieces, getting gradually smaller with the size of wood, finishing with kindling wood at the top. Put the firelighter amongst the kindling wood at the top and light. Close the door sufficient to give an opening of about 10 mm. This slight opening of the door will feed air rapidly into the fire, like holding a hair dryer in position.

The heat from the firelighter and kindling wood will warm the chimney, which increases the draw on the fire. The lit kindling will gradually light the bigger, denser pieces of wood below. Lighting a fire in this manner will make lighting the fire easier, will keep the door glass cleaner and also reduce emissions up the chimney in the lighting process.

Once the fire is well lit (generally about 10 minutes), close the door and operate the Wood Stove using the air controls to feed in the right amount of air for the required heat output.



Wood Stacking for Top Down Lighting

WOOD STOVES

Free Standing

8 Kw Cube	8 Kw	320m ³
10 Kw Versions	10 Kw	400m ³
12 Kw Curve	12 Kw	480m ³
13 Kw Versions	13 Kw	520m ³
14 Kw Double Sided	14 Kw	560m ³
18 Kw Single or Double Sided Convection	18 Kw	720m ³

Inserts

8 Kw Insert	8 Kw	320m ³
10 Kw Insert	10 Kw	400m ³
13 Kw Insert	13 Kw	520m ³
14 Kw Double Sided Insert	14 Kw	560m ³
18 Kw Single or Double Sided Insert	18 Kw	720m ³

WARRANTY

- 5 Year warranty on wood stoves

Infiniti Fires™ is a registered trademark. Our designs and products are protected with patents and design applications.

Please visit our website for information on installation manuals, warranty and dealer locations etc.

Infiniti Fires continues to develop and improve its products. It reserves the right to update specifications without prior notice.

www.infinitifires.co.za